

Raise — The — SHED



* This is a rendering and is subject to change.

For 135 years, the South Dakota State Fair has been a place to celebrate youth and agriculture. Since the early 1950s, the Open Class Sheep Barn has been a part of that celebration. It held many memories and has been an important part of the culture of the South Dakota State Fairgrounds, but since the old barn had outlived its' useful life, it is time to **'RAISE The SHED.'**

The SHED will be the new home for Open Class Sheep during the annual State Fair and will serve as a multi-use facility for other livestock and equine events during non-fair time.

The footprint will encompass an area in between the 4-H Livestock Complex and National Guard Armory

- 40,000 square foot sheep and multi-purpose facility
- 1320 square foot education center
- 792 square foot mezzanine
- Able to accommodate 1,000 head of sheep
- 30 bay wash rack
- 2,300 square foot show ring
- Restrooms

THE ESTIMATED COST IS \$8 MILLION WITH A FUNDRAISING GOAL OF \$3 MILLION

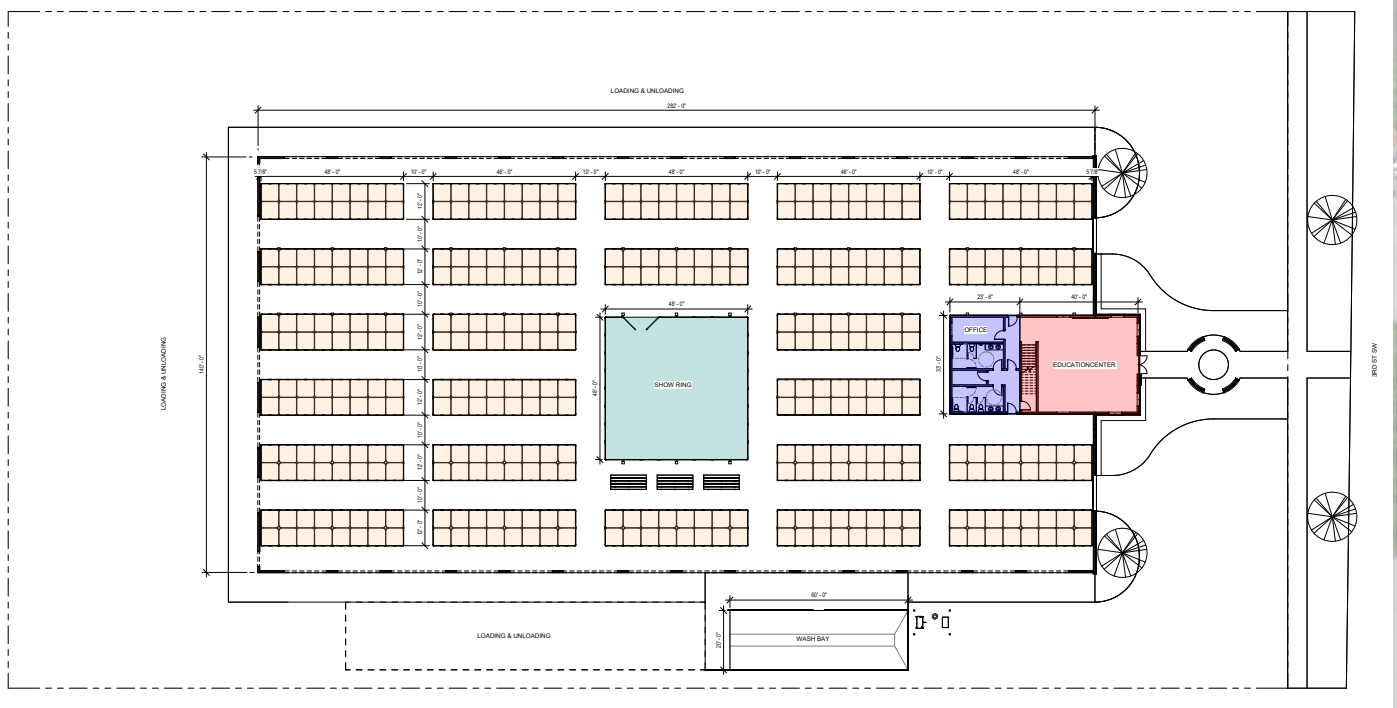



SHOW RING



MEZZANINE



EDUCATION CENTER



DONOR ALLEY

VISION TIMELINE

- **FUNDRAISING**
September 2022-September 2023
- **DESIGN**
Spring 2024
- **GROUNDBREAKING**
2024 South Dakota State Fair
- **GRAND OPENING**
2025 South Dakota State Fair

